

Because you're not like everyone else.

luma ●●●™
comfort



AIR PURIFIER
AP170W / AP400W
OWNER'S MANUAL

BECAUSE YOU'RE NOT LIKE EVERYONE ELSE.

And neither are we. Always at the forefront of our industry, our goal is to offer the best quality product and consumer value on the market. Our team is constantly pushing the boundaries of innovation and design to create exceptional products to help you achieve a more comfortable living or work space.

Our goal is to ensure that every Luma Comfort customer is 100% satisfied with their product. If you have any questions or concerns regarding your product, or if you would simply like to share an idea with us, please feel free to contact us. Our friendly and knowledgeable customer support team is here for you. Call us today at **866-737-6390** or email **support@lumacomfort.com**.

For future reference, we recommend you attach a copy of your sales receipt here and record the following information. You will need this information if it becomes necessary to contact the manufacturer for service inquiries.

Date of Purchase: _____

Serial Number: _____

Model Number: _____



Connect with us online.

● ● ● CONTENTS

Important Safety Information	4
Get To Know Your Air Purifier	5
Product Benefits	5
Parts Diagram.....	5
Set Up Instructions	6
Operating Instructions.....	7
Control Panel and Indicators	7
Replacing the Filters	8
Maintenance	9
Technical Support.....	10
Product Specifications	10
Troubleshooting	10
Warranty	11

SAVE THESE INSTRUCTIONS



Please carefully read this manual before attempting to use this air purifier. For your own safety, comply with all safety instructions and warnings contained in this owner's manual to prevent personal injury or property damage.

For best results, we recommend operating your air purifier 24 hours a day, 7 days a week, in a room with the windows and doors closed.

● ● ● IMPORTANT SAFETY INFORMATION



These instructions are not meant to cover every possible condition and situation that may occur. Please read all instructions before using this air purifier. Failure to carefully read all instructions may result in possible electric shock or fire hazard, and will void the manufacturer's warranty.

1. Use this air purifier only as instructed in this owner's manual. Other uses may cause electric shock, injury or fire.
2. Close supervision is required if this air purifier is used near children or pets.
3. To protect against electric shock, do not immerse this air purifier or its plug and cord in water.
4. If the air purifier is being transported or will not be in use, disconnect it from the power supply by tightly gripping the plug and pulling it from the power outlet. Do not disconnect the power supply by pulling on the air purifier's power cord.
5. Avoid contact with any of the air purifier's moving parts.
6. Place the air purifier on a level surface.
7. This air purifier is designed for indoor use only. Do not use this air purifier outdoors.
8. Do not use this air purifier without the HEPA filter installed. Doing so could result in permanent motor damage.
9. This air purifier's plug is intended to fit into a matching receptacle. Under no circumstances should the plug be altered in any way. An improper connection can result in electric shock. 
10. If possible, avoid using extension cords with this air purifier. If an extension cord is absolutely necessary, do not use more than one extension cord to operate more than one unit.
11. Do not insert objects or allow fingers to enter into the air purifier's air inlet, as this may cause electric shock or bodily injury. Do not block or tamper with the air purifier while it is in operation.
12. Do not run the power cord under mats or carpeting, and do not cover the power cord with runners. Arrange the power cord away from room traffic and where it can be tripped over.
13. Do not operate this air purifier in the presence of flammable substances or explosives.
14. Do not place the air purifier near an open flame or cooking/heating appliances.
15. Do not expose the air purifier to moisture and do not use it in bathrooms, laundry rooms or other damp areas.
16. Do not use this air purifier with any solid-state speed control devices.
17. Do not place heavy objects on the air purifier.
18. This product is not intended for use in commercial or industrial areas.
19. If the air purifier will not be in use, unplug it from the power supply.
20. If the air purifier plug or power cord is damaged, do not attempt to repair the components t 1-866-737-6390 or have the unit examined by an authorized service provider. 

●●● GET TO KNOW YOUR AIR PURIFIER

PRODUCT BENEFITS

- Significantly reduces airborne contaminants and improves indoor air quality
- Effective airflow design quickly exhausts clean, purified air back into your room
- HEPA filter effectively captures over 99% of particles down to 0.1 micron
- Activated carbon pre-filter captures large dust particles and reduces cooking, tobacco and pet odors
- Advanced photo catalyst TiO₂ filter and UV light reduce organic pollutants such as formaldehyde, benzene and ammonia, as well as kill bacteria and viruses
- Modern, flat panel design fits in with any decor
- Whisper-quiet fan draws air into the unit without disturbing your environment
- Energy-efficient and uses as much electricity as a light bulb

PARTS DIAGRAM

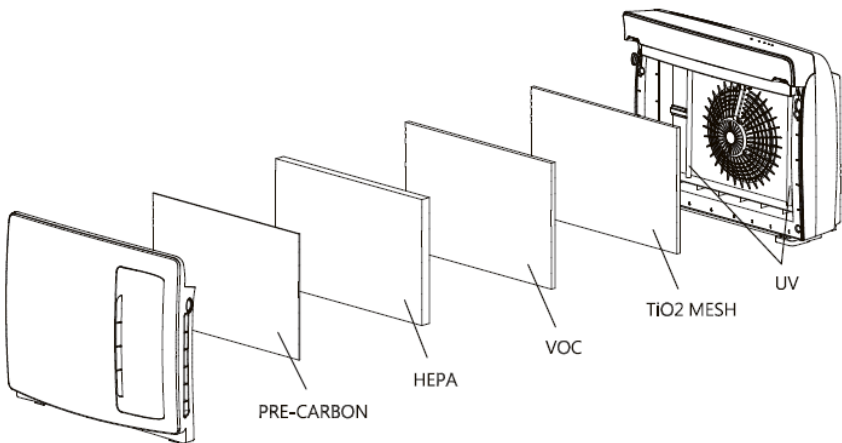

Say Goodbye to Ugly Products

● ● ● SET UP INSTRUCTIONS

Carefully remove all packaging materials and retain for future storage/use. The air purifier arrives fully assembled, but the internal filters are packaged for shipping and must be unwrapped and reinstalled before use.

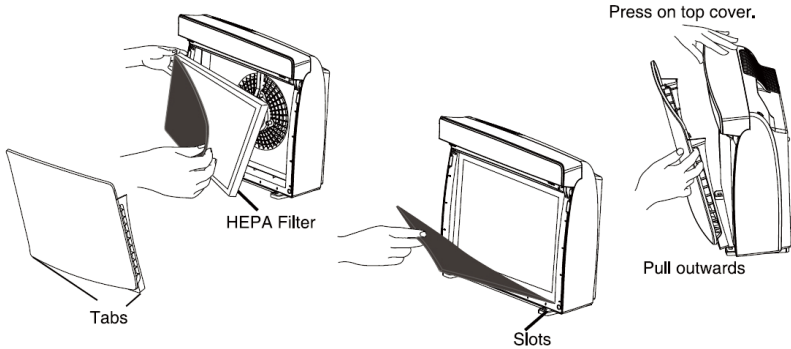

- Open the air purifier's front grill by placing your hand on top of the air purifier's cover, inserting your finger in the slot on the side of the unit and by pulling the front cover out.
- Unwrap the filters and ensure that all of the supplied filters are properly installed and in the correct order: carbon prefilter, HEPA filter, VOC filter, TiO₂ mesh filter and UV (refer to parts list). Please note that the AP170W and AP400W models do not have the ionizer function. Never operate the air purifier without the HEPA filter properly installed.
- Choose a suitable location for your air purifier. For best results, use the air purifier in an enclosed area with the doors and windows closed. Also, as a general rule, the closer your air purifier is located to the pollution source, the better the air purifying performance.
- Position the air purifier near a power outlet and plug the connector end of the power cord into the power outlet.
- We recommend running the unit on high speed for a few seconds before each use. After operating it on high speed, you may then adjust the unit to run at your desired speed.

● ● ● OPERATING INSTRUCTIONS

CONTROL PANEL AND INDICATORS

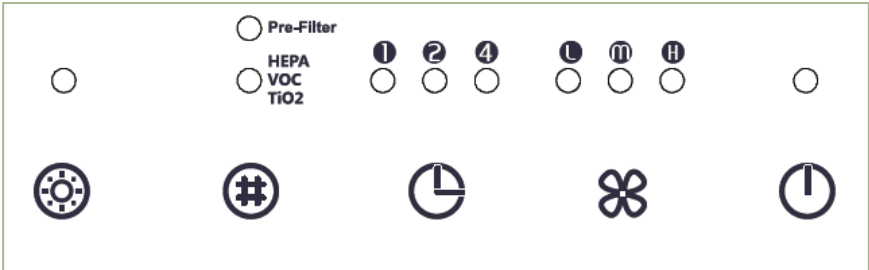

UV Function



FILTER



TIMER



FAN



POWER

- Once the air purifier is plugged in, press the power button to turn the unit on. Press the same button to turn it off.
- Press the fan button to select the fan speed. There are three different fan speeds: low (L), medium (M), and high (H).
- Press the clock button to turn on the automatic timer. The timer can be set from 1 to 7 hours. The air purifier will turn off once the set time has been reached.
- Press the UV button to turn on the UV function and press it again to turn this function off. UV light is used to destroy organic contaminants such as viruses, mold and bacteria.
- The filter indicator light will turn on when the filters need to be replaced. After you have replaced the filter(s), press and hold the filter button for several seconds until the filter indicator light turns off. Doing so will also reset the automatic timer.

REPLACING THE FILTERS

The air purifier's filters will need to be replaced periodically. When the filters need to be replaced, the filter indicator light will turn on.

The life of the filters will depend on the amount of contaminants in the air and the frequency of use. As a general rule, the HEPA, VOC and TiO₂ filters will last approximately 180-365 days while the carbon filter will last approximately 60-90 days. Do not wash and reuse any of the filters.

The HEPA filter in particular will need to be replaced when it turns brown. You will also notice that the air volume will dramatically decrease at this time. We recommend having a set of replacement filters on hand to ensure maximum performance.

- a. Before replacing any of the filters, turn the air purifier off and unplug it from the power outlet.
- b. Open the air purifier's front grill by placing your hand on top of the air purifier's cover, inserting your finger in the slot on the side of the unit and by pulling the front cover out.
- c. Remove and discard any used filters.
- d. Remove all packaging from the new filters and replace the filters in the order shown in the parts list section.
- e. Replace the air purifier's front cover.
- f. After the filters have been replaced, plug the unit back into the power supply and turn it on. Press and hold the filter button for several seconds to reset the filter indicator.

● ● ● MAINTENANCE

Regular cleaning and maintenance is an essential step in maintaining the longevity of your air purifier and ensuring that it operates free of defects. Maintain your air purifier by following these steps:

- Always unplug the air purifier from the power supply before servicing or cleaning.
- Use a soft cloth and a mild soap and warm water solution to clean the unit's exterior, particularly the air intake grills and air outlet. Do not use harsh cleaners, gasoline, paint thinner, benzene, etc., as these substances can damage the air purifier.
- Thoroughly dry all of the air purifier parts with a soft cloth before reconnecting the unit to the power supply.
- If the air purifier will not be in use for an extended period of time, place the unit back in its original carton and keep it stored in a clean, dry place.

● ● ● TECHNICAL SUPPORT

Luma Comfort is committed to providing a premier service experience. If you are experiencing any technical issues with your product related to either setup or operation, please contact our product support team at 1-866-737-6390 or support@lumacomfort.com.

PRODUCT SPECIFICATIONS

Model:	AP170W	AP400W
Product Dimensions:	12.2" x 7.7" x 14.4"	22.2" x 9.9" x 18.6"
Product Weight:	8.8 pounds	18.5 pounds
Voltage:	110V-120V	110V-120V
Wattage:	48W	100w
Coverage Area:	170 sq. ft.	500 sq. ft
Purification Methods:	HEPA filter, carbon filter, UV light, TiO2 filter & VOC filter	
Fan Speeds:	3	
Noise Level (dB):	53.25/52.4/50.5	57.2/51.6/48.6
Filter Life Indicator:	Yes	
Timer:	1-7 hours	
Contaminants Removed:	Dust, pollen, bacteria, viruses, chemicals	
Warranty:	1 year manufacturer's warranty	

TROUBLESHOOTING

Problem	Possible Cause(s)	Possible Solution



WARRANTY

Luma Comfort products are warranted to be free from defects in workmanship or materials for one (1) year from the date of purchase. If the product is found to be defective within this period, Luma Comfort, at its sole option, will repair or replace any components that fail during normal operation. The repairs or replacement will be made at no charge to the customer for parts and labor, assuming that the customer shall be responsible for all transportation costs to and from Luma Comfort. Luma Comfort retains the right to repair or replace (with a new or newly-refurbished replacement product) the appliance at its sole discretion. This warranty does NOT apply to the following:

- Products without a proof of purchase
- Products purchased from a source other than an authorized Luma Comfort dealer
- Cosmetic damage such as scratches or dents
- Damage caused by service performed by anyone who is not an authorized service provider of Luma Comfort
- Damage in transit
- Damage caused by accident, abuse, misuse, water, flood, fire, improper installation, maintenance negligence, commercial use for a non-commercial unit, acts of God or any other acts of nature or external causes
- Damage to a product caused by modifications or alterations without the written permission of Luma Comfort
- Normal wear and tear of parts that are designed to be replaced, such as filters or batteries
- Power failure and improper power supply such as low voltage, defective wiring or inadequate fuses
- Use of force or damage caused by external influences
- Complete or partially dismantled appliances

THE WARRANTIES AND REMEDIES CONTAINED HEREIN ARE EXCLUSIVE AND IN LIEU OF ALL OTHER WARRANTIES EXPRESS, IMPLIED, OR STATUTORY, INCLUDING ANY LIABILITY ARISING UNDER ANY WARRANTY OF MERCHANTABILITY OR FITNESS FOR A PARTICULAR PURPOSE, STATUTORY OR OTHERWISE. THIS WARRANTY GIVES YOU SPECIFIC LEGAL RIGHTS, WHICH MAY VARY FROM STATE TO STATE.

IN NO EVENT SHALL LUMA COMFORT BE LIABLE FOR ANY INCIDENTAL, SPECIAL, INDIRECT, OR CONSEQUENTIAL DAMAGES, WHETHER RESULTING FROM THE USE, MISUSE, OR INABILITY TO USE THIS PRODUCT OR FROM DEFECTS IN THE PRODUCT. SOME STATES DO NOT ALLOW THE EXCLUSION OF INCIDENTAL OR CONSEQUENTIAL DAMAGES, SO THE ABOVE LIMITATIONS MAY NOT APPLY TO YOU.

If you believe your product is defective, contact Luma Comfort for warranty service at 1-866-737-6390 or support@lumacomfort.com. In your correspondence with Luma Comfort, please describe the problem and request a return material authorization (RMA) number. You will also need to provide the proof of purchase, return shipping address and a daytime phone number.

After a Luma Comfort representative confirms that your product is defective and is still under warranty, you will receive an RMA and return shipping instructions. Products sent to our headquarters without an RMA will be refused.

Say Goodbye to Ugly Products